

# STAINLESS STEEL PREDATOR CAMERA



**DESIGNED  
& MANUFACTURED  
IN EUROPE**

**Ruggedised Stainless  
Steel High Speed Pan,  
Tilt & Zoom Camera**

  
**360VISION**  
TECHNOLOGY



# Stainless Steel Predator Camera

The ideal choice for effective 24-hour surveillance and intrusion detection, Predator cameras include analogue and 1/1.28" Sony HD equipped models that deliver incredible colour or mono images during the hours of darkness.

The Stainless Steel Predator camera includes all the popular features of the standard Predator but in a compact and robust housing, fabricated from anti-corrosion 316L stainless steel with matt finish as standard.

Designed to withstand the toughest of operational environments, Predator Stainless Steel is also competitively priced, with the high-performance package targeted to offer the advantages of extreme temperature (-50°C to +65°C with optional heater) camera performance, but at a fraction of the cost of other stainless steel PTZ cameras.

■ Stainless Steel Predator Thermal 'Hybrid' camera option available



# Support & Compatibility

Our commitment to the ONVIF organisation also extends to constant and proactive direct communication with leading VMS manufacturers to ensure full feature and operational compatibility.

Our standard warranty is 3 years. In addition, our new and innovative support package provides an extremely low cost 5 year warranty extension – offering additional layers of benefit for customers' framework and maintenance agreements.

We believe in our manufacturing quality, and we do not subscribe to the low cost/replace ideology so prevalent in our industry – let us show you how our fixed fee service will actually save you money!

### Low Power

'Low Power Mode' for inactive periods of operation, 'Intelligent Illumination' and 'Night Setting Presets' to control the illumination activity and low consumption components that all add up to greatly reduced power device for applications such as solar, fuel, battery and other low voltage sensitive applications.

### On Board Recording

Recording options of up to 256Gb give network backup, time lapse, FTP and alarm recording. Network sensing automatically senses when connection is lost to ensure that full HD, real time images can be recorded inside the camera, ensuring no information is lost.

### Latest Camera Modules

All Stainless Steel Predator cameras now benefit from ULTRA low light technology from the stunning new 1/2.8" ULL sensors.

Larger sensor = brighter, crisper and more defined colour images at night.

### 360 Degree View

Continuous rotation pan, unobstructed 360 degree view, 180 degree tilt all contribute to unhindered views usually associated with Dome alternatives.

### Ruggedised

316L stainless steel is a low-carbon austenitic steel with high corrosion resistance, especially to chloride and sulfurous acids. It is commonly used in marine and industrial applications, such as petrochemical, food processing, and wastewater treatment.

Our ruggedised cameras are designed to withstand harsh environments, such as extreme temperatures, dust, moisture, and vibrations.

In addition, IK10 is the highest impact protection rating for electrical enclosures, meaning they can resist 20 joules of external mechanical shock or impact.

### Paint Options

Standard high quality paint finish and optional long life 'Extreme' paint finish for marine/coastal applications.

This ensures the operational and aesthetic features of the Stainless Steel Predator are protected.

### Attack Detect Feature

Stainless Steel Predator's Attack Detect feature ensures if a physical attack is detected, the camera will automatically return to its original position – ensuring no loss of evidential footage.

### Direct Drive Mechanism

Unlike many competitor products that utilise belt based drive systems, Stainless Steel Predator incorporates ultra reliable and extremely quiet Direct Drive mechanisms, resulting in long life, high (and consistent) preset accuracy and long term reliability.

### Dedicated Setup Apps

3 apps for Discovery, Configuration and Update. With an innovative thumbnail index, select and program from one central Network point. No need for browser add-ins, security permissions or Internet necessary updates.

### IR + LED White Light

Predator Stainless Steel offers a comprehensive range of IR and/or white light illumination options - featuring distances up to 300m. White light offers powerful illumination for overt applications, intruder tracking and deterrence.

HD RANGE	40 X HD ULTRA
Colour / Mono	YES
Imager	1 / 2.8" Type Exmor
Zoom Optical / Digital	40 x, 12 x
Pixels (Effective)	Approx 2.38 Megapixels
Horizontal view angle	66 [W] °-1.9 ° [T]
Lens Size	4.25 -170 mm
Min Sensitivity - Colour	0.001 Lux
Min Sensitivity - Mono Int	0.0002 Lux
Signal Noise Ratio	>50 dB
Picture Flip	YES
Picture Freeze	YES
PRODUCT FEATURES - All Predator Cameras have the following functions	
Stainless Steel	316 stainless steel
Focus / Iris	Auto / Manual
Presets	360
Tours	4 [Max 90 Presets per tour]
Learned Patrols	4 Mimic tours - up to 30 minutes duration each
Privacy Zones	Up to 24
Variable pan speed / coverage	0.1-120° / Sec 360 ° continuous rotation, absolute positioning
Variable tilt speed / coverage	0.1-120° / Sec 180 ° absolute positioning
Auto Homing	Goes to preset, tour or mimic tour after prescribed time
Col / Mono Change over	4 Levels 3 fixed, 1 custom / user defined
Operating Temperature	- 50V °C to + 65 °C with optional heater
Power	24Vdc to 36 Vdc or PoE
Mounting options	Wall, Corner, Pole and Soffit
Certification	UKCA, CE & FCC approval: Ingress IP68: Impact IK10 : vibration & shock certified approvals. Independent power certification and Elexon Charge Codes available
SIRIUS ILLUMINATION (OPTIONAL)	IR & WHITE LIGHT
SIR 275	IR Only
SIR250WL	IR / White light Combination

CODEC	25/50fps	ASPECT	30/60fps
1080P	1920x1080	16:9	1920x1080
720P	1280x720	16:9	1280x720
576P	1024x576	16:9	1024x576
480P	720x480	3:2	720x480
240P	320x240	4:3	320x240
D1	720x576	4:3	720x480
VGA	640x480	4:3	640x480
SXGA*	1280x1024	5:4	1280x1024
XGA*	1024x768	4:3	1024x768
QVGA	320x240	4:3	320x240
Distribution*	Multi Streaming Codec, 2 independently configurable profiles		
Image Compression	H.264, MJPEG, H.265		
Protocols	TCP/IP, IPv4, ONVIF (S), 802.1x, MD5, TLS, PEAP, HTTP, HTTPS, RTP, RTSP, RTSP over HTTPS, 360SDK, QoS, IGMP v3, SNMP v3, NTP, FTP, Digest Authentication		
Compression levels	CBR, VBR		

\*some restrictions apply

Standard Paint Options	RAL		RAL
Black	9005	Cool Grey	7035
White	9003	Mild Grey	7001





## Predator with no lamps

### Weight: 13kg

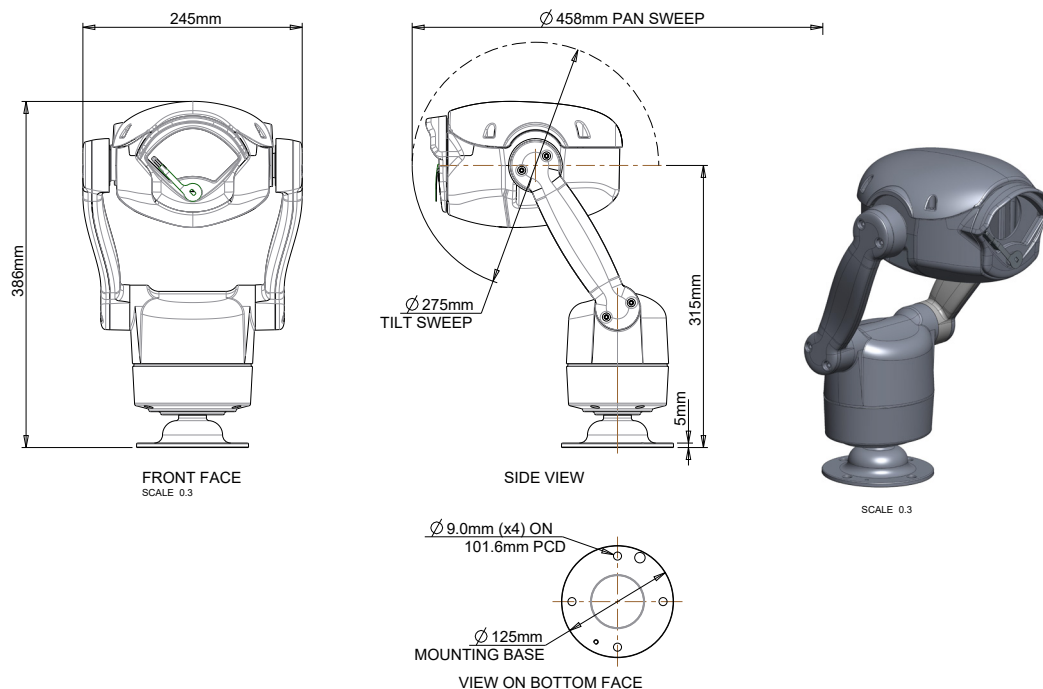

## Predator Bracketry

### Wall Bracket

### Weight: 3kg

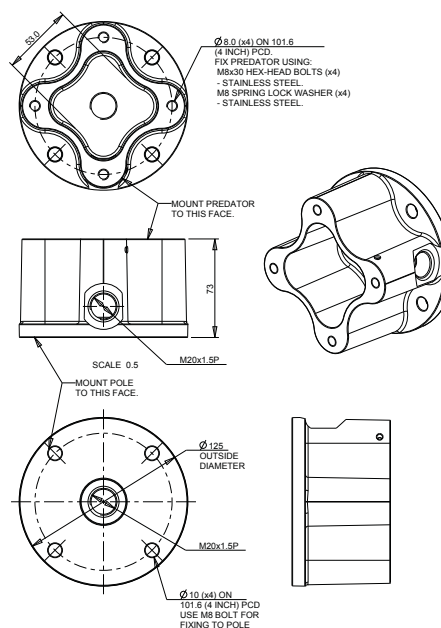
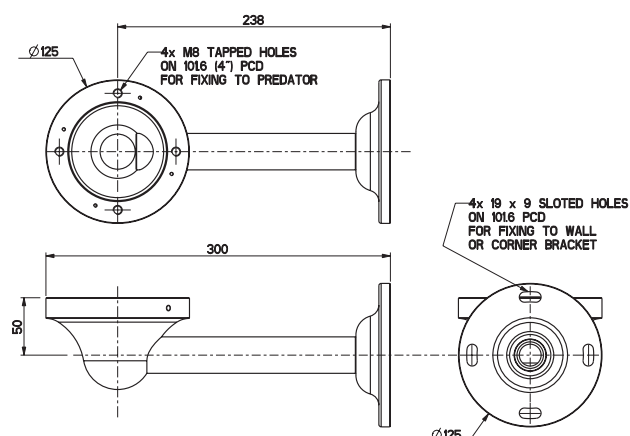

All trademarks are used courtesy of registered owners. STAINLESS STEEL PREDATOR is a registered trademark of 360 Vision Technology Ltd. The manufacturer reserves the right to change specifications without notice.

## 360 Vision Technology Ltd

Unit 7 Seymour Court, Manor Park,  
Runcorn, Cheshire WA7 1SY UK

T: +44 (0)1928 570000

info@360visiontechnology.com

www.360visiontechnology.com

