



Product Brochure

PREDATOR



Dual lamp unit shown (covers IR175SW, 200SWL and IR200 products), other colours available.



Product Data Sheet

PREDATOR



High Speed High Definition Ruggedised Pan, Tilt and Zoom Camera

UK Manufacture

Designed and manufactured in the UK

Warranty

3 year's FULL warranty

Innovative Night Vision

Dual IR & White Light for COLOUR at NIGHT

IP68 Certification

IP68 certified for the harshest of environments

Multi-Protocol Integration

The PREDATOR range comes with multi-protocols as standard allowing complete integration with many leading DVRs, Matrices and IP systems

OSD

PREDATOR's OSD enables full access to all functions using either 3rd party protocols or 360 Vision Technology's control systems

Quality Standard

Excellence in design and manufacture ensure all 360 Vision products offer exceptional quality combined with ultra reliability

Privacy Zones

24 privacy zones are available with simple joystick positioning and sizing

Extreme Low Light Capability

Frame integration cameras give usable video images as low as 0.01 lux

Colour/Mono Cameras

The PREDATOR range includes 18x, 28x, or 44x zoom with autofocus featuring Sony ExView, Wide Dynamic Range (WDR) camera technology which gives excellent low light performance. 360 Vision software enables the colour/mono switch over levels to specific lighting conditions



Dual lamp unit shown (covers IR175SW, 200SWL and IR200 products), other colours available.



Product Data Sheet

PREDATOR



Predator
High Intensity Long Range LED array
Weight: 8.5kg

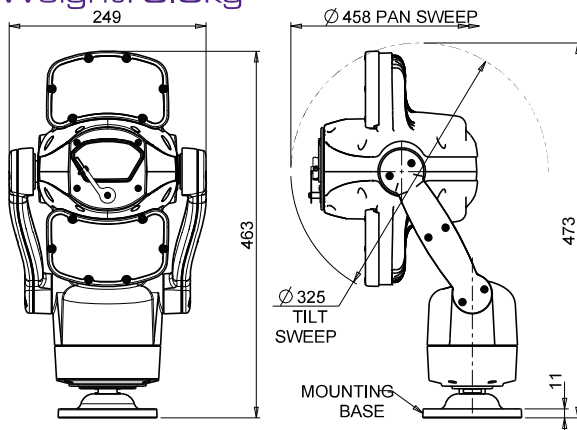

Covers IR350 and IR400S
Spot product.

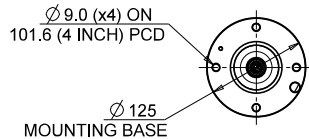

Predator
High Intensity Single LED array
Weight: 8kg

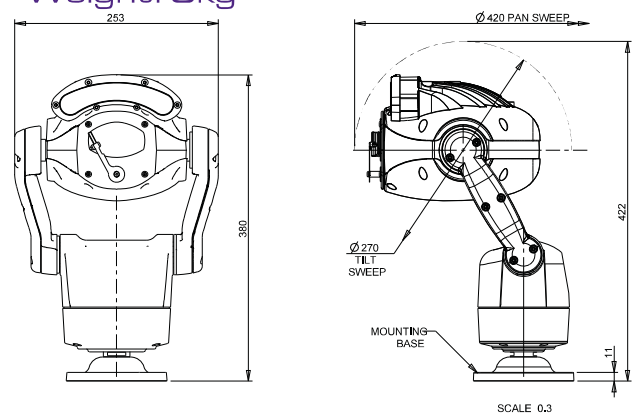

SCALE 0.3

Covers IR80, IR110WL and IR130 products.

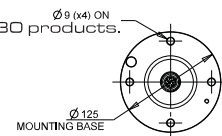

Predator
High Intensity Dual LED array
Weight: 8.5kg

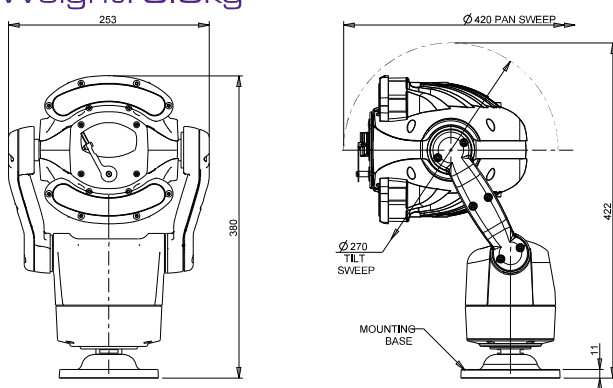

Covers IR175SW, 200SWL and IR200
products.

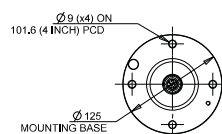

Predator
High Intensity Dual LED array
Weight: 8.9kg

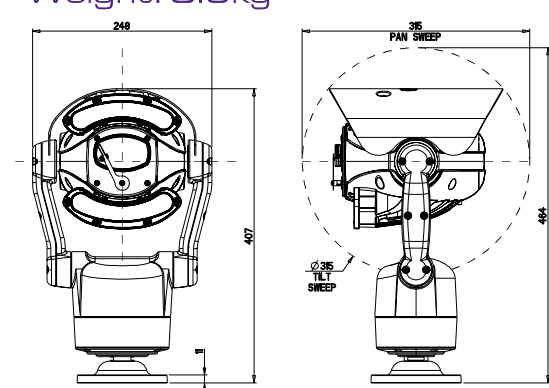

**Straight Arm version
c/w Sunshield**

Covers IR175SW, 200SWL and IR200
products.

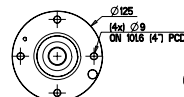

Weight: 9.5kg



Corner Bracket

Weight: 2.2kg

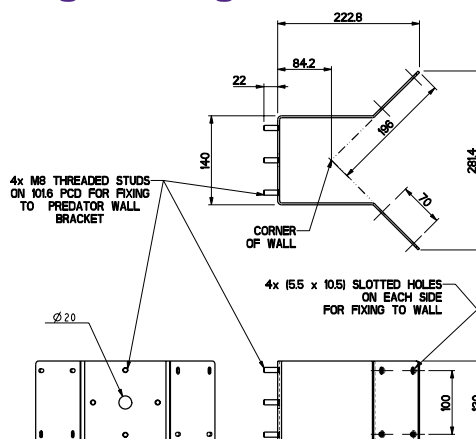

Weight: 1 kg

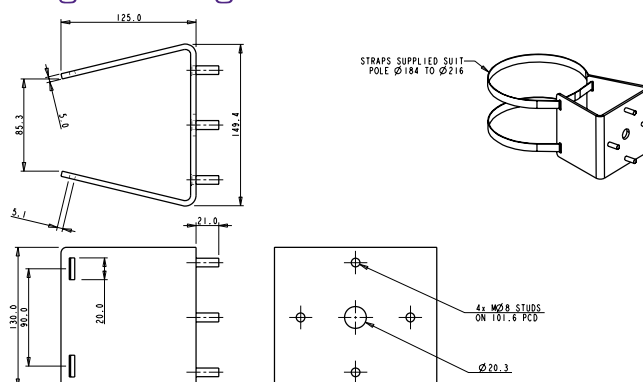

PRODUCT SPECIFICATION	Sony 18x Col/Mono	Sony 28x Col/Mono	Sony 44x Col/Mono
Colour/Mono	Yes	Yes	Yes
Imager	1/4" type Super-HAD CCD II	1/4" type Super-HAD CCD II	1/4" type Super-HAD CCD II
Zoom - Optical + Digital	18x, 12x	28x, 12x	44x, 12x
Zoom - Total	216x	336x	528x
Line Resolution	670	670	670
Horizontal view angle	2.8°[T] - 48°[W]	2.1°[T] - 55.8°[W]	1.6°[T] - 68.8°[W]
Lens Size	4.1 - 73.8mm	3.5 - 98mm	3.06 - 134mm
Min Sensitivity - colour	0.4 Lux	0.4 Lux	0.6 Lux
Min Sensitivity - mono Int	0.01 Lux	0.01 Lux	0.01 Lux
Signal Noise Ratio	>50dB	>50dB	>50dB
Picture Flip	Yes	Yes	Yes
PRODUCT FEATURES	ALL PREDATOR units have the following functions		
Video Output	1V p to p, 75 Ω		
Scanning	PAL or NTSC		
Focus/Iris	Auto/Manual		
Presets	360		
Tours	4 (max 90 presets per tour)		
Learned Patrols	4 mimic tours - up to 30 minutes duration each		
Privacy Zones	Up to 24		
Telemetry	Coaxial or RS485		
Protocols - includes	360, Pelco P/D/Coax, Ultrak RS485, Forward Vision, VCL RS485/Coax		
Variable pan speed/coverage	0.1 - 120°/sec, 360° continuous rotation, absolute positioning		
Variable tilt speed/coverage	0.1 - 120°/sec, 180°, absolute positioning		
Auto Homing	Goes to preset, tour or mimic tour after prescribed time		
Col/Mono Changeover	4 levels - 3 fixed, 1 custom/user defined		
Operating temperature	-50°C to +60°C with optional heater		
Power	24vac 160VA		
Mounting options	Wall, Corner, Pole and Soffit		
Certification	CE & FCC approval; Ingress IP68; Impact IK 10; Vibration & Shock certified approvals		
SIRIUS ILLUMINATION	IR & WHITE LIGHT (Nominal)		
IR80	IR 80 metres		
IR 110WL	IR 110 metres, WL 110 metres		
IR 130	IR 130 metres		
IR 175WL	IR 175 metres, WL 175 metres		
IR200	IR 200 metres		
200SWL	WL 200 metres		
IR350	IR 350 metres		
IR400S Spot	IR 400 metres		
WEIGHTS			
Predator (No LED's)	7.5kg		
Predator (Single LED array)	8kg		
Predator (Dual LED array)	8.5kg		
Predator (HMA, No LED's)	9.5kg		
Predator (Dual Long Range)	8.5kg		
Standard Paint Options	RAL		
White	9003		
Black	9005		
Cool Grey	7035		
Mid Grey	7001		

HMA: Hinged Mounting Adapter



Hinged Mounting Adapter (HMA) is designed to assist in the installation of the Predator allowing access to the cable connections 'hands free'.

Installers can now install the Predator using standard cables, so no need for pre-made cables. Enabling the Predator to be positioned up to 100 metres from the power supply (dependent on Predator/ cable specification).

All trademarks are used courtesy of registered owners. PREDATOR is a registered trademark of 360 Vision Technology Ltd. The manufacturer reserves the right to change specifications without notice.



360VISION
TECHNOLOGY